



Project \_\_\_\_\_  
 Item # \_\_\_\_\_  
 Quantity \_\_\_\_\_

## Narrow LED Display Lights

Models: NLL-30, -36, -42, -48, -54, -60

Narrow LED Display Lights are Hatco's slim style that is ideal for installation in tight spaces, but emit little or no heat. Providing a bright display area, the LED lighting is ideal above refrigerated product areas where an attractive glow is needed to enhance your food products. This lighting will deliver significant savings because of lower energy consumption, longer bulb lifetime and greater reliability.

### Standard features

- Available in widths from 30" to 60" (762 to 1524 mm)
- 120 volt, single phase only with On/Off rocker switch
- Supplied with non-adjustable 1.5" (38 mm) angle brackets for under-shelf mounting
- Utilizing LED lighting, ideal above refrigerated product areas (not recommended for installation above or near a steam table or other steam generating appliance)
- Optional *Designer* powdercoated colors, Gloss finishes, Plated finishes and Stainless Steel housing available
- 6" (152 mm) leads (no conduits)

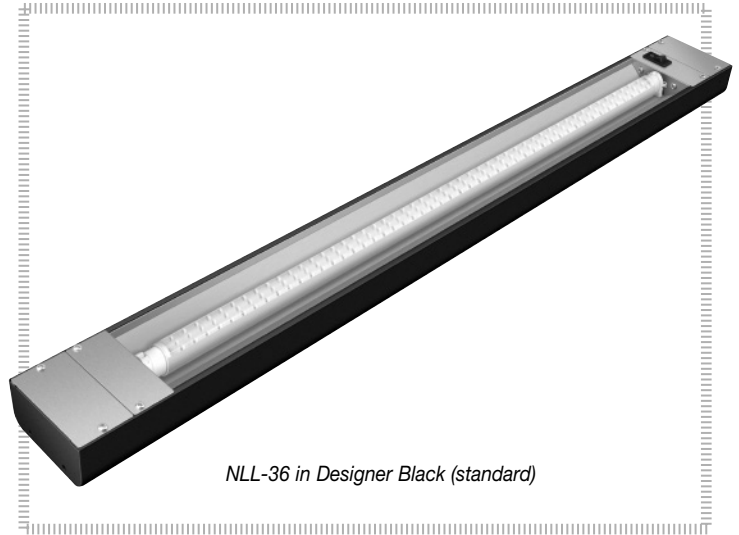

NLL-36 in Designer Black (standard)

### Options (available at time of purchase only)

*Designer Colors* – Non-standard colors are non-returnable –

- Warm Red     Black (standard)     Gray Granite     White Granite  
 Navy Blue     Hunter Green     Antique Copper

*Gloss Finishes* – Non-standard colors are non-returnable –

- Smooth White     Gleaming Gold     Glossy Gray  
 Bold Black

*Plated Finishes* – Special process required and extended lead times, non-standard colors are non-returnable –

- Bright Brass     Bright Nickel     Bright Copper  
 Antique Nickel     Antique Brass     Antique Bronze

All Stainless Steel Exterior – Non-standard colors are non-returnable –

*Extended Electrical Leads* – for any SU, SL or SR mount unit, must specify lead length

- 1'-5" (305-1525 mm)     6'-10" (1829-3048 mm)  
 11'-15" (3352-4572 mm)     16'-20" (4877-6096 mm)

*Power Locations*

- Left     Right

*Non-Adjustable Tubular Stands with a clearance of:*

- 10" or 12" (254-305 mm)     14"-16" (356-406 mm)

*Non-Adjustable Tubular Stand Color*

Aluminum (standard)

*Designer Colors* – Non-standard colors are non-returnable –

- Warm Red     Black     Gray Granite     White Granite  
 Navy Blue     Hunter Green     Antique Copper

*Gloss Finishes* – Non-standard colors are non-returnable –

- Smooth White     Gleaming Gold     Glossy Gray  
 Bold Black



HATCO CORPORATION | P.O. Box 340500 Milwaukee, WI 53234-0500 U.S.A.

(800) 558-0607 | (414) 671-6350 | www.hatcocorp.com | equipsales@hatcocorp.com | intl@hatcocorp.com



# Narrow LED Display Lights

Models: NLL-30, -36, -42, -48, -54, -60

NLL-XX

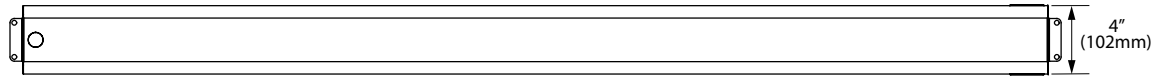

TOP VIEW

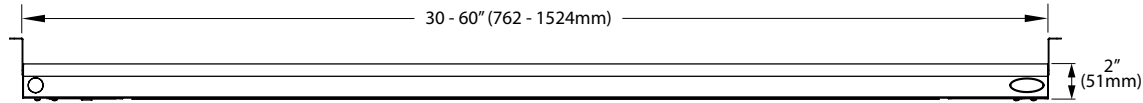

FRONT VIEW

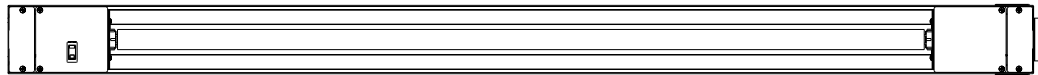

BOTTOM VIEW



END VIEW

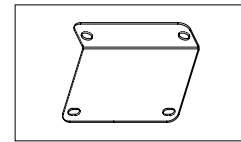

Non-Adjustable Angle Bracket

## SPECIFICATIONS Narrow LED Display Lights

Model	Dimensions (Width x Depth x Height)	Bulb Length	Voltage	Phase	Watts	Amps	Ship Weight*
NLL-30	30" x 4" x 2" (762 x 102 x 51 mm)	2' (610 mm)	120	1	15	.13	7 lbs. (3 kg)
NLL-36	36" x 4" x 2" (914 x 102 x 51 mm)	2' (610 mm)	120	1	15	.13	8 lbs. (4 kg)
NLL-42	42" x 4" x 2" (1067 x 102 x 51 mm)	3' (914 mm)	120	1	19	.16	9 lbs. (4 kg)
NLL-48	48" x 4" x 2" (1219 x 102 x 51 mm)	3' (914 mm)	120	1	19	.16	10 lbs. (5 kg)
NLL-54	54" x 4" x 2" (1372 x 102 x 51 mm)	4' (1219 mm)	120	1	22	.18	11 lbs. (5 kg)
NLL-60	60" x 4" x 2" (1524 x 102 x 51 mm)	4' (1219 mm)	120	1	22	.18	12 lbs. (6 kg)

\* Shipping weight includes packaging.

## PRODUCT SPECS Narrow LED Display Lights

The Narrow LED Display Lights, manufactured by the Hatco Corporation, Milwaukee, WI 53234 U.S.A.

The Narrow LED Display Lights shall be ... , rated at ... watts, ... volts, single phase and be ... inches (millimeters) in overall width.

The Narrow LED Display Lights shall consist of Stainless Steel, Designer, Gloss, or Plated finish housing and include as standard equipment non-adjustable 1½" (38 mm) angle brackets.

The light shall be factory assembled ready for electrical installation.

Options shall include extended electrical leads, and non-adjustable tubular stands.

Warranty consists of 24/7 parts and service assistance (U.S. and Canada only).

HATCO CORPORATION | P.O. Box 340500 Milwaukee, WI 53234-0500 U.S.A.

(800) 558-0607 | (414) 671-6350 | www.hatcocorp.com | equipmentsales@hatcocorp.com | intl@hatcocorp.com